

HR-03 GT Heatsink

Exploded View

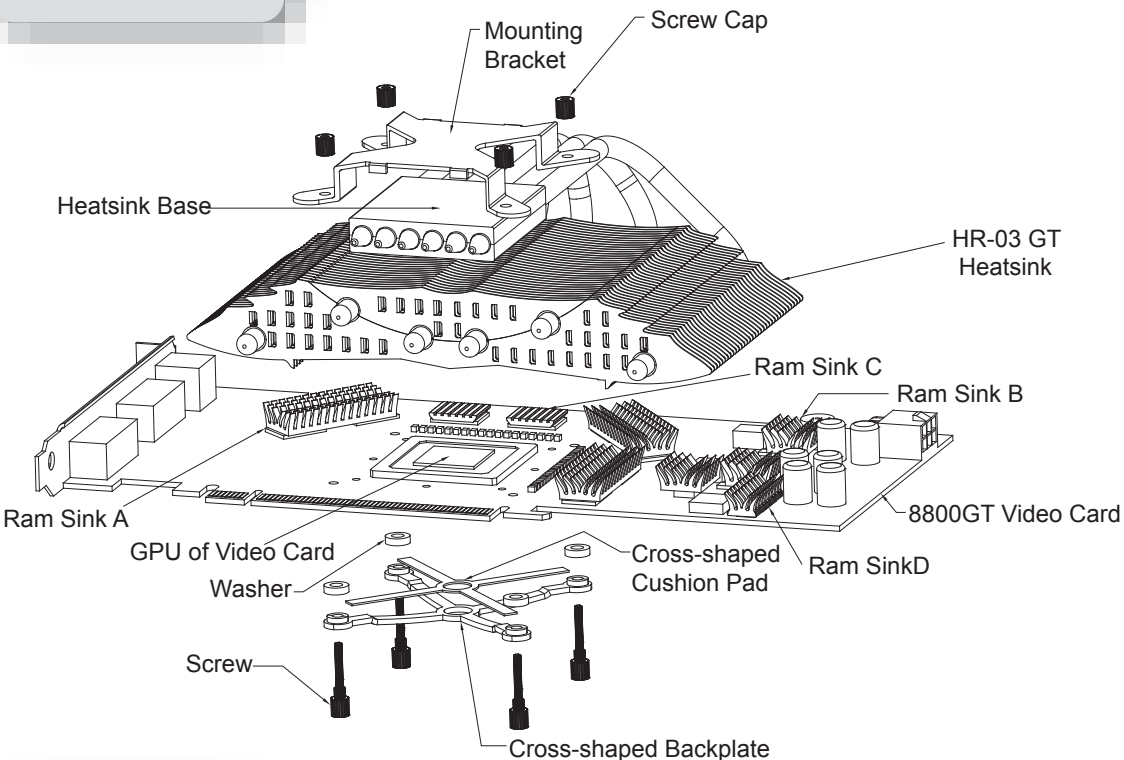

Component

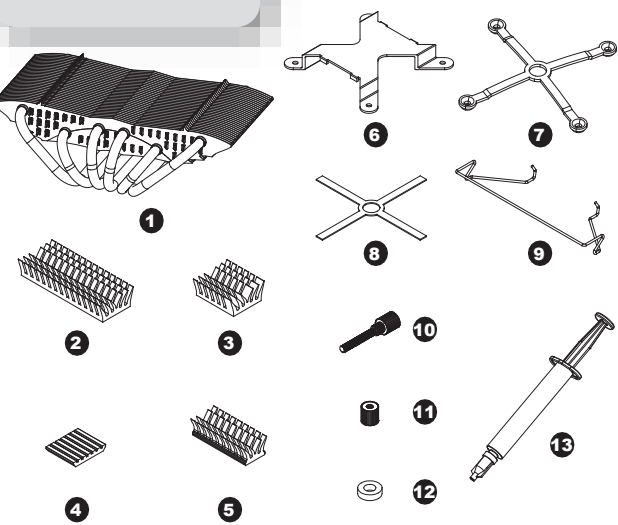

Parts Name	Piece(s)
1 HR-03 GT Heatsink	1
2 RAM Sink A	3
3 RAM Sink B	3
4 RAM Sink C	3
5 RAM Sink D	1
6 Bracket Mount	1
7 Cross-shaped Backplate	1
8 Cross-shaped Cushion Pad	1
9 Fan Wire Clip	2
10 Screws	4
11 Nut/Screw Cap	4
12 Washer	4
13 Thermal Paste	1

Installation

Important! Before proceeding with installation, please check for the most up-to-date instructions at www.thermalright.com
 There are two types of installation method. Please choose the best one to fit your system setup and configuration. Type 1 and Type 2 methods share the same Step 1.

Step 1 : Thermal Paste and RAM sinks Application

Remove stock cooler and thorough clean the surface of GPU and RAM chipsets, making sure oily residue is removed completely. Apply a thin layer of thermal paste to heatsink base and GPU. Unpeel the backing of the RAM sinks (A, B, C and D) and stick them to the appropriate RAM chipsets (see illustration on the right for reference).

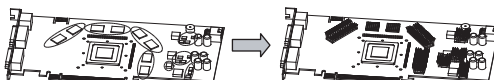

TYPE 1

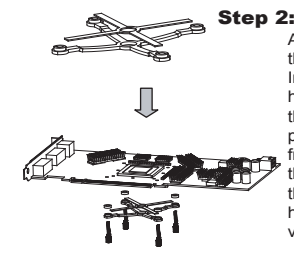

Step 2: Backplate Installation

Apply the adhesive padding to the cross-shaped backplate. Insert the screws through the holes from the backplate and then screw them in to secure in place. Then insert the washers from the other side and through the thread. Finally, insert the threads through the mounting holes from the back of the video card.

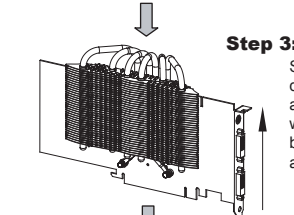

Step 3: Heatsink Installation

Slide the heatsink in the direction depicted by the arrow from the illustration with the video card in between the heatpipes and the heatsink base.

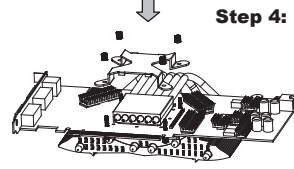

Step 4: Mounting Bracket Installation

Have the heatsink base in full contact with the GPU. Have the mounting bracket slide through the threads from the screws and place it firmly on the heatsink base.

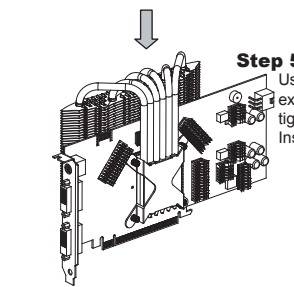

Step 5: Installation Complete

Use the four screw caps on the exposed threads and turn till finger tight to secure heatsink in place. Installation complete.

TYPE 2

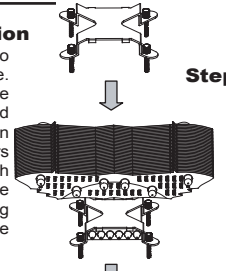

Step 2: Mounting Bracket Installation

Insert screws through the holes on the mounting bracket and place the mounting bracket on top of the heatsink base.

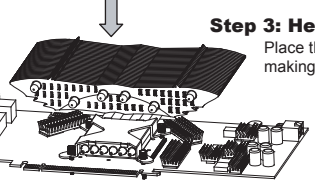

Step 3: Heatsink Installation

Place the heatsink on top of GPU making sure of a full contact.

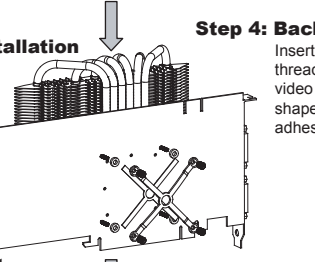

Step 4: Backplate Installation

Insert the washers through the threads on the backside of the video card and then the cross-shaped backplate with the adhesive padding on it.

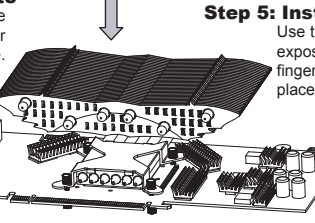

Step 5: Installation Complete

Use the four screw caps on the exposed threads and turn till finger tight to secure heatsink in place. Installation complete.

* Fan Installation

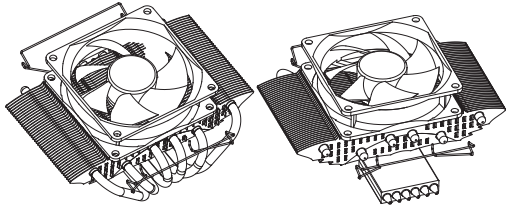

Insert each end of fan wire clip into the holes on the fin (See illustration for reference). Place any 92 x 25mm fan on top of heatsink. Pull on fan wire clip to hook into fan mounting holes. Fan installation complete.